



A LUXURY ABODE  
IN OLD GURUGRAM

SECTOR 12 A

# AMAARA RESIDENCES

Amaara Residences is not just an address, but a thoughtful development designed keeping in mind the aspirations and needs of your loved ones. This gated society, located in bustling sector 12 A, Gurugram, focuses on creating a comfortable and close-knit living experience amidst pristine natural surroundings.

Adorned by the world class amenities, Amaara is a beautiful blend of comforts and strategic conveniences. The residential complex houses well designed club house, jogging tracks, sit-outs and landscaped parks.

*This privileged address is where happiness resides.*



## EXTRAORDINARY LIFESTYLE

## COMMUNITY LIVING

## SAFE & SECURE ENVIRONS

## PREMIUM CLUB HOUSE



AESTHETICALLY  
DESIGNED COMPLEX  
WORLD CLASS  
ENTRANCE LOBBY  
HI- SPEED ELEVATORS



CENTRAL GREENS WITH  
SIT-OUTS  
WALKING TRACKS  
E-LIBRARY  
MULTI-PURPOSE HALL



GATED COMPLEX  
MULTI - TIER SECURITY



SWIMMING POOL  
YOGA ROOM  
MEDITATION AREA  
WORLD CLASS GYM  
GAMES ROOM





A BEAUTIFUL BLEND OF  
COMFORTS & STRATEGIC  
CONVENIENCES



## 3BHK+SERVANT

CARPET AREA  
1445 SQ. FT.

BALCONY AREA  
348.22 SQ. FT.

SUPER BUILT-UP AREA  
2473 SQ. FT.



**Note:** Dimensions mentioned are unfinished dimensions.

## 3BHK

CARPET AREA  
1194 SQ. FT.

BALCONY AREA  
285.46 SQ. FT.

SUPER BUILT-UP AREA  
1912 SQ. FT.

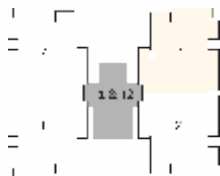

**Note:** Dimensions mentioned are unfinished dimensions.

## LOCATION MAP



### Corporate Office:

C-7A, 2nd Floor, Omaze City Centre Mall, Sohna Road, Sec. 49, Gurugram, Haryana

### Marketing & Sales Office:

49, Ground Floor, JMD Megapolis, Sohna Road, Gurugram - 122018, Haryana

### Regd. Office:

Flat No. 3, Palm Apartment, Plot No. 13B, Sec. 6, Dwarka, New Delhi

**Tel** 0124-2219440, 4078333

**Email** [info@amaararesidences.com](mailto:info@amaararesidences.com)

**Web** [www.amaararesidences.com](http://www.amaararesidences.com)

Project Strategizing by



**PAREENA**  
INFRASTRUCTURES  
PVT. LTD.

**DISCLAIMER:** Images depicted in the brochure are computer generated, artistic and neither they are actual images nor exact representation of buildings to be constructed. In the opinion of the firm the words/phrases used are generic in terms. The depicted images are only for reference being indicative in nature and to help prospective customer to perceive the locational attributes of project and the basic nature of structure. Therefore, the images in brochure shall not be solely considered or relied as benchmark for investment in project. The firm, its employees and associates shall not be held responsible for any loss, injury or damages incurred, if any, to and by any prospective customer, due to any decision taken by any prospective customer based on such images, since the completed buildings may differ from depicted images. Thus it is advised that all concerned and interested prospective customers should consider the above facts and should not rely solely upon the images so depicted for taking any decision for investing in the project. License No. 86 of 2017 dated 16 / 10 / 2017 land measuring 3.75 acres at village Gurugram, Sector-12A, Gurugram in the name of Gyasi Ram and others collaboration with M/S Stanford Developers & Infrastructure Registered with HARERA Vide Regd No. RC / REP / HARERA / GGM / 2018 / 02 dated 23 / 04 / 2018. Building Plans Approval Vide Memo no. ZP-1197 / SD (BS) / 2018 / 7914 dated 06 / 03 / 2018. Approval documents are available for viewing at the Developer's Corporate Office at Gurugram. 1 sq. mtr. = 1.196 sq.yds. and 1 sq. mtr. = 10.764 sq.ft.